

Product Installation Guidelines

Version 2, 7 February 2024, Page 1 of 5
Document No.: 001.00.30.10

GalvinLab/Ezy-Wash CP-BS Lead Safe Lab Gooseneck/Upswept Outlets

PRODUCT CODES:

- 167.92.25.01
- 167.92.23.01

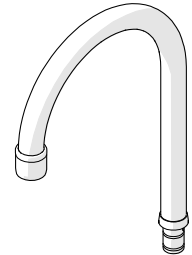

PRODUCTS

Item Code	Description	WELS Rating	Water Consumption	Nominal Flow Rate
167.92.25.01	GalvinLab CP-BS Lead Safe Lab Gooseneck Outlet Only 200 CC x 180 High w/ Aerator	5	6.0	5.8
167.92.23.01	GalvinLab CP-BS Lead Safe Lab Gooseneck Outlet Only 200 CC x 120 High w/ Aerator	6*	3.5	3.39

SPECIFICATIONS

- Galvin Engineering recommends the installation of strainers and pressure reducing valves prior to installing the exposed shower units to ensure clean consistent water supply. Debris or poor water quality could cause the units to seize or fail.
- GalvinLab laboratory tapware is manufactured specifically to handle the knocks and hazardous chemicals present in a laboratory environment.
- Lead Safe™ brass construction. *

IMPORTANT: All GalvinLab outlets are tested in accordance with AS/NZS 3718 and leave our premises in good working order.

*Our Lead Safe™ product range is compliant with the Lead-Free Requirements of the NCC 2022 Vol. 3, Clause A5G4 (2) and NSF/ANSI 372.

WARNINGS: Special attentions to be paid on notes, photos, images, or drawings of assembly steps marked with the warning symbol.



TECHNICAL DATA

Inlet	Spout Connection	
Outlet	Aerator	
Headworks	N/A	
Working Pressure Range (kPa)	Min	50
	Max	500
Working Temperature Range (°C)	Min	5
	Max	65
Material	Brass	
Finish	Chrome	

NOTE: Galvin Engineering continually strives to improve their products. Specifications may change without notice. Higher temperature or pressures could result in premature failure and void the manufacturer's warranty.

TOOLS REQUIRED

- Hex key

PRE-INSTALLATION - DIMENSIONS

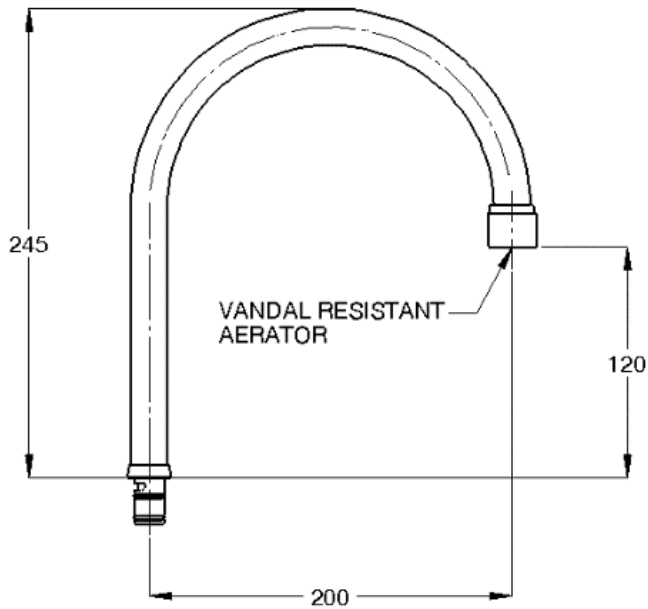

167.92.23.01

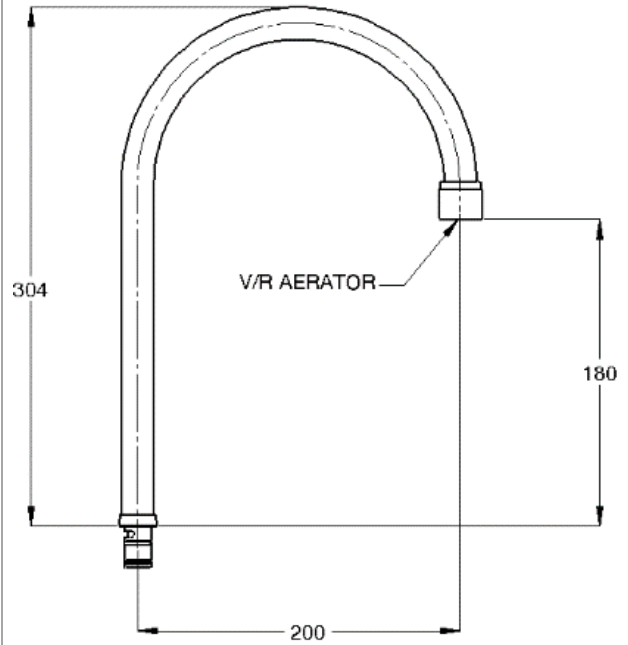

167.92.25.01

INSTALLATION

INSTALLATION COMPLIANCE: Galvin Engineering products must be installed in accordance with these installation instructions and in accordance with AS/NZS 3500, the PCA and your local regulatory requirements. Water and/or electrical supply conditions must also comply to the applicable national and/or state standards. Failing to comply with these provisions shall void the product warranty and may affect the performance of the product.

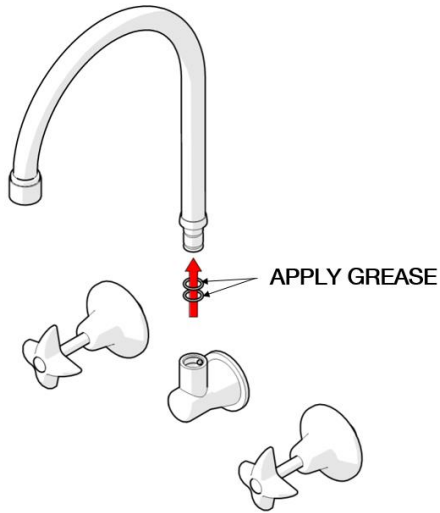

1. Grease O-rings

- Grease O-rings before inserting the spout connection in the outlet body (not supplied).

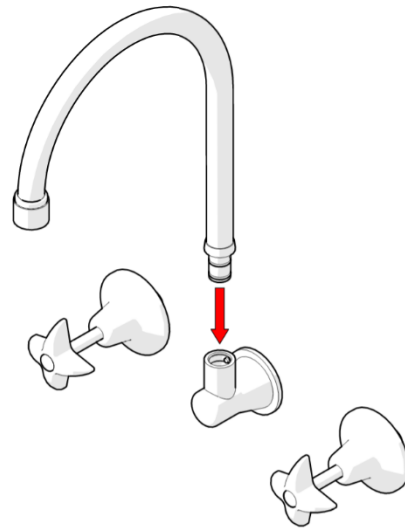

2. Fit spout

- Fit the spout in the outlet body (not supplied).

Note: The spout is fitted to a tapware body for illustration purposes only. Spout can also be fitted to other bodies as applicable.

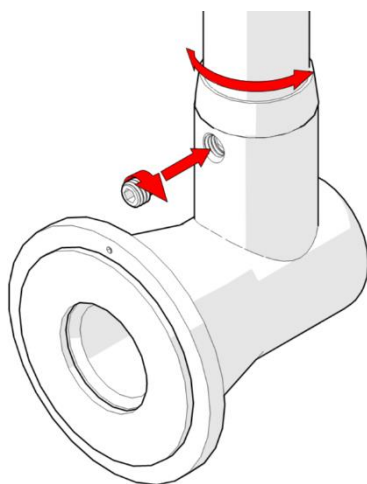

3. Secure outlet

- Tighten grub screw using a hex key.

Note: Do not overtighten grub screw.

Ensure spout swivels freely once installed.



4. Testing

- Turn on water and test the unit for any leaks.

DUAL-STAR RATED ITEMS (WELS)

Due to some state requirements, items are required to be in higher star rating (6-star). Therefore, for some items, two flow regulators are supplied. Primarily, the higher star-rated flow regulator is equipped in the assembly.

Items	Primary Flow Regulator	Alternative Flow Regulator
167.92.23.01	6-stars (blue)	5-stars (black)

CHANGING FLOW REGULATOR (167.92.23.01 ONLY)

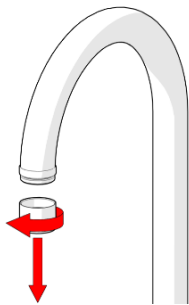

1. Remove Aerator Housing

- Turn housing in an anti-clockwise direction to loosen and to remove as shown. For vandal-resistant type, use supplied tool to remove housing.

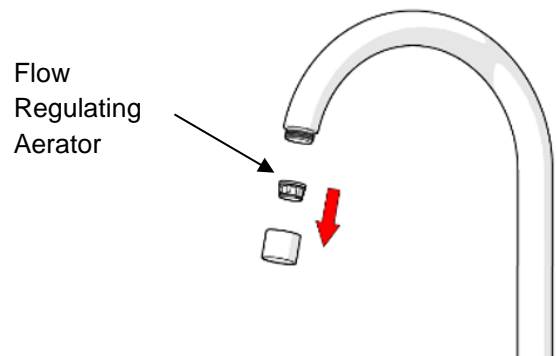

2. Remove & Swap

- Remove the flow regulating aerator.
- Fit the supplied alternative flow regulating aerator.

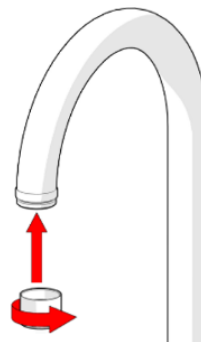
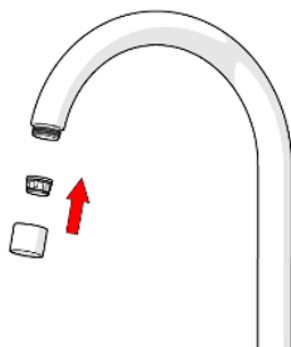

3. Reassemble

- Reverse steps 2 & 1 to reassemble ensuring correct orientation.
- Test for leaks and correct operation

TROUBLESHOOTING

PROBLEM	CAUSE	RECTIFICATION
No water flow	Water is turned off	Turn water on
	Flow regulator is blocked by debris	Remove flow regulator from spout and remove debris. Install an inline strainer.

WARRANTY

The warranty set forth herein is given expressly and is the only warranty given by the Galvin Engineering Pty Ltd. With respect to the product, Galvin Engineering Pty Ltd makes no other warranties, express or implied. Galvin Engineering Pty. Ltd. hereby specifically disclaims all other warranties, express or implied, including but not limited to the implied warranties of merchantability and fitness for a particular purpose.

Galvin Engineering Pty Ltd products are covered under our manufacturer’s warranty available for download from www.galvinengineering.com.au Galvin Engineering Pty Ltd expressly warrants that the product is free from operational defects in workmanship and materials for the warranty period as shown on the schedule in the manufacturer’s warranty. During the warranty period, Galvin Engineering will replace or repair any defective products manufactured by Galvin Engineering without charge, so long as the terms of the Manufacturer’s warranty are complied with.

The remedy described in the first paragraph of this warranty shall constitute the sole and exclusive remedy for breach of warranty, and Galvin Engineering Pty Ltd shall not be responsible for any incidental, special or consequential damages, including without limitation, lost profits or the cost of repairing or replacing other property which is damaged if this product does not work properly, other costs resulting from labour charges, delays, vandalism, negligence, fouling caused by foreign material, damage from adverse water conditions, chemical, electrical or any other circumstances over which Galvin Engineering has no control. This warranty shall be invalidated by any abuse, misuse, misapplication, improper installation or improper maintenance or alteration of the product.